

Visu Slat Self-Stand Signs

For desk, counter, table, etc... Choose from complete and ready to use kits (right) or choose your own elements, in which case you will need:

- 1- one Face Plate (p.2)
- 2- one pair of end caps (p.3) optional
- 3- two or three Stand Clips (cat.#255DS)

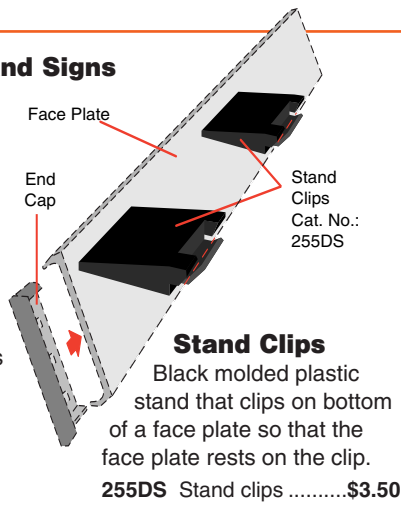

Self Standing Sign Kits

Desk or counter signs, consist of a face plate and stand clips. The stand clip snap-fits onto the back bottom of the faceplate.

NOTE: 2 stand clips are needed for Face Plates up to 18". 3 stand clips should be used for longer plates.

TO ORDER SPECIFY:

- Series #2052D
- Size in table

Face Plate Size	Bronze	
	Silver	Gold, Black
15/8" x 12" Little	\$19.15	\$26.10
15/8" x 18" Little	\$23.80	\$34.25
23/8" x 12" Middle	\$22.80	\$29.25
23/8" x 18" Middle	\$29.05	\$38.75
31/8" x 12" Big	\$27.85	\$36.50
31/8" x 18" Big	\$34.85	\$51.25
43/4" x 12" King	\$36.65	\$50.05
43/4" x 18" King	\$48.50	\$67.95

SIGN KITS INCLUDE: 2 stand clips & 1 pair of end caps.

LETTERING to your specifications, extra at \$.75 /character installed. Minimum 10\$.

Visu-Slat System B: Double Faced Slats - Modular Interior Signage

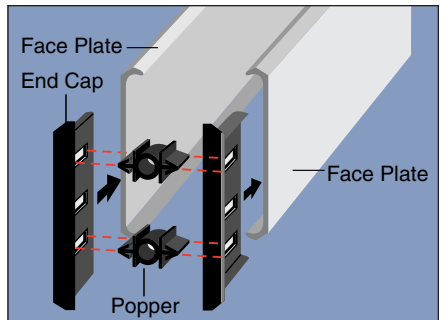

ASSEMBLY: Double Faced Signs

- 1- Fix Visu-Slat End Caps to 2 Face Plates
- 2- Insert Visu-Slat Poppers into End Cap slots
- 3- Join the 2 Face Plates together

Double Faced Right Angle Projection Signs

To project double faced Visu-Slats remove 1 set of Visu-Slat Caps & screw them to background surface through holes in Visu-Slat Poppers then snap on Visu-Slat Face Plate. This will firmly project Visu-Slats up to 20" long.

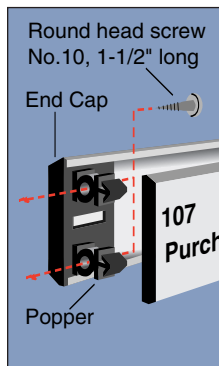

Double Faced Ceiling Suspension Signs

To suspend double faced Visu-Slats rotate poppers in their slots until holes are facing downward. Thread black plastic coated suspension wires and spacers (if more than 1 sign) through holes.

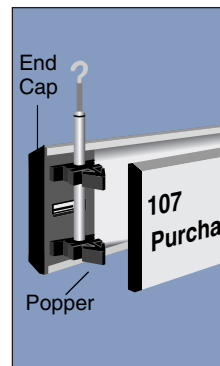

Suspension Wire 20SSW Black coated with top hooks...\$1.65 /ft

Visu Slat Poppers
Poppers join 2 Face Plates back to back by attaching to Visu-slat end Caps (see p.3)
21S51P \$1.65 /2

MAGNETICALLY ALIGNED
Patents U.S. 3942147 / 4023290 Can.1019570 / 1043100

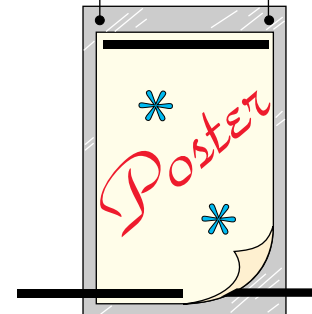

Poster Holder kit

MAGNETIC Display posters by suspending them under ceiling. Place poster on sheet of polyester & hold them together sandwiched between 2 magnetic strips, top & bottom. Polyester sheet is attached to ceiling by hooks & wires.

included with every kit • 24" x 36" polyester sheet • four 22" magnetic strips • two ceiling hooks with wires

0820041\$39.50

Visu Slat Double Faced Signs

Size	Silver	Bronze, Gold, Black
Projecting Signs SPECIFY: •#2052P •Size		
3" x 12"	\$ 61.30	\$ 80.85
43/4" x 18"	\$104.85	\$144.10
61/4" x 12"	\$102.85	\$133.10
61/4" x 18"	\$134.20	\$181.50
Suspended Signs SPECIFY: •#2052S •Size		
61/4" x 24" (1 sign)	\$167.20	\$229.90
61/4" x 36" (1 sign)	\$243.10	\$337.70
61/4" x 48" (1 sign)	\$309.10	\$434.50

LETTERING to your specifications, extra at \$.75 / character installed. Min. 10\$.

COLORS:

Silver	Other colors on request
Gold	
Bronze	
Black	

DISCOUNTS/RABAI\$
\$300 to 599 -5%
\$600 to 999 -10%
\$1000 & over -15%

CUSTOM SIZES

For other lengths than those listed at the bottom of the page, you may assemble your own elements. For each Double Faced sign you need:

- 1 - Two identical face plates (see p.2)
- 2 - Two pairs of end caps (see p.3)
- 3 - Two pairs of poppers (above right)